

Symmetry Safety 3-Panel Door

Exclusively offered by Symmetry Elevating Solutions



Symmetry Safety 3-Panel Door with Clear vision panels

Available with:

- Power car door operation
- Vision panels
- Multiple finish options

Symmetry Exclusive

The Symmetry Safety 3-Panel Door is one of the most reliable residential elevator car doors on the market. When coupled with the Flush Mount Door and/or Frame Package, our Safety 3-Panel Door creates a minimal amount of space between the elevator car door and landing door.

Standard Features

- Manual Car Door Operation: The trailing panel of the car door measures 2 inches from edge of the car sill and is designed to fit within requirements of the $\frac{3}{4}$ " x 4" rule, with maximum running clearance and maximum hoistway door set back of $\frac{3}{4}$ inch
- Height of Opening: 7'0"
- Car Door Opening: 33 inches clear opening (fits in a "typical" hoistway with a 36 inch wide car)
- Standard Finish: Black

Optional Features

- Light Curtain: Standard as secondary protective device if the unit is installed under ASME A17.1 (2013 and prior); optional if it is installed under ASME A17.1 (2016 and newer)
- Power Car Door Operation
- Height of Opening: 7'11"; custom heights available
- Car Door Opening: 36 inches clear opening (fits in a "typical" hoistway with a 40 inch wide car)
- Vision Panels: Available with Clear or Smoked acrylic
- Car Door: Available in Stainless Steel or powder-coated steel

This brochure is intended for INFORMATIONAL PURPOSES ONLY and SHOULD NOT be used for construction.

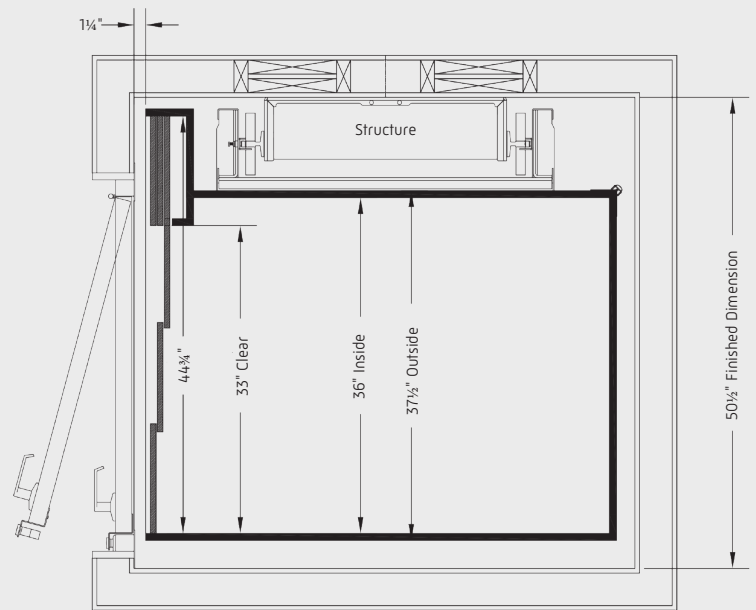

Shown with Symmetry Flush Mount Landing Door Package



Shown in Black with vision panel, Brushed Stainless Steel and Vintage Bronze

Available Color Options

Full selection of RAL colors available.



Black standard



Vintage Bronze



Stainless Steel



Ivory



Architectural White



Grey



Bin Silver



Cast Bronze



Goldsmith

Available Acrylic Options



Clear



Smoked